

PROSERIES
PART No: PRO7218
STANDARD ADJUSTABLE QUICK RELEASE TBM
INSTALLATION INSTRUCTIONS

PLEASE ENSURE THAT INSTRUCTIONS ARE UNDERSTOOD PRIOR TO FITMENT

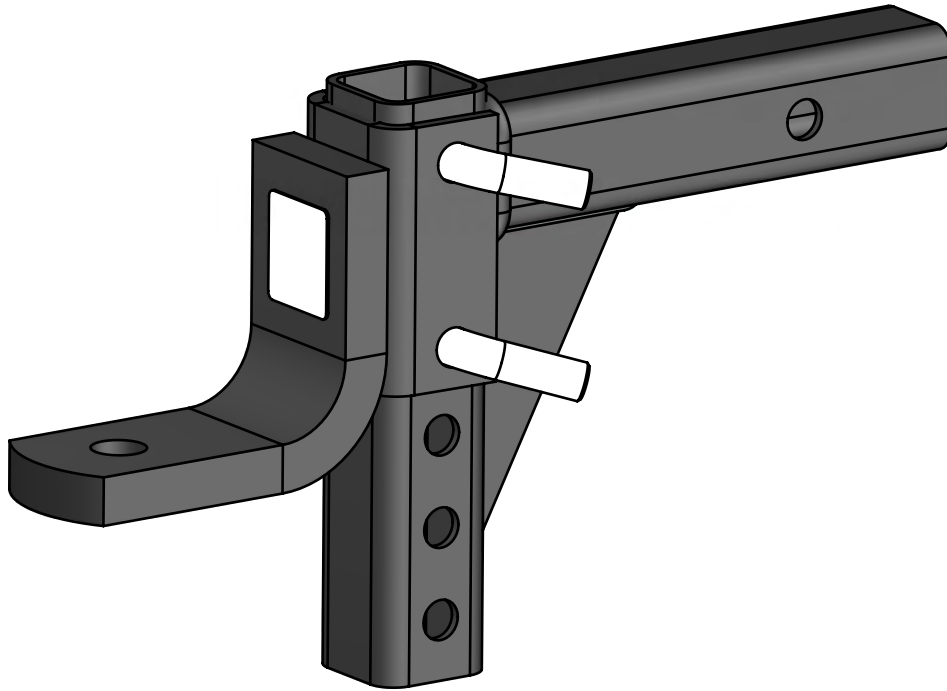

ADJUSTABLE QUICK RELEASE KIT
Installation Instructions

Part Number: PRO7218
Installation Time: Approx 5 Mins



PROSERIES
PART No: PRO7218
**STANDARD ADJUSTABLE QUICK RELEASE TBM
INSTALLATION INSTRUCTIONS**

PLEASE ENSURE THAT INSTRUCTIONS ARE UNDERSTOOD PRIOR TO FITMENT

Warning:

1. Do not drill, cut, weld or otherwise modify the Adjustable head assembly .
2. If you are using electric welding on a motor vehicle, always check that the vehicle is not equipped with electronic engine or instrument management equipment. Failure to do so could destroy any onboard computers. If in doubt, check with the vehicle's manufacturer.

General :

1. Ensure all hardware items have been included, refer to assembly diagram.
2. It is recommended that the instructions are read through and completely understood before making any attempt to fit this product.
3. Be wary of any changes to vehicle designs or other accessories that may conflict with the installation of this product.
4. The Pull pin and R-Clip supplied with this product were used to achieve the specified rating. If replacement is required ensure the same rating & quality pull pin and R-Clips are used.

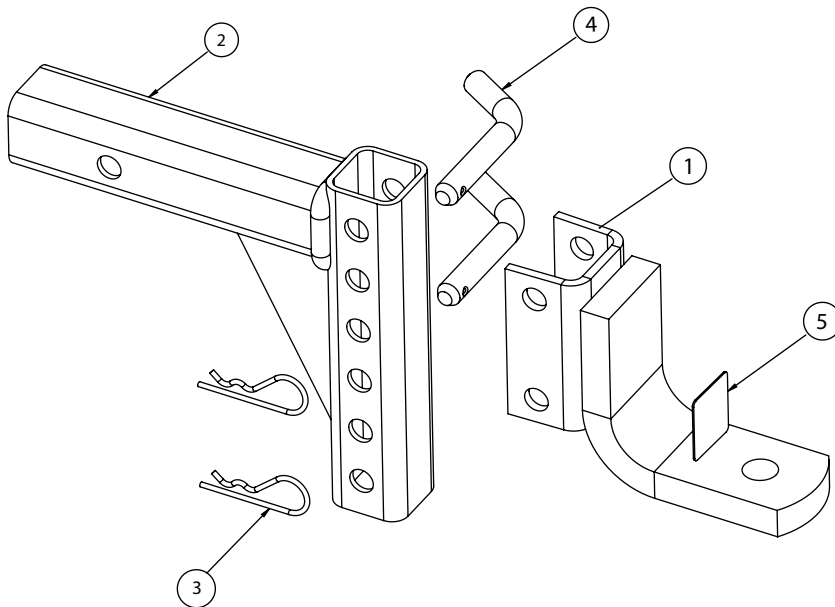

QTY	DESCRIPTION	ITEM NO
1	ADJUSTABLE TRAILER BALL MOUNT	1
1	SHANK	2
2	R CLIP	3
2	PULL PIN	4
1	ACRYLIC RATING LABEL	5

Fitment of Adjustable Head Kit –

- 1 Align the holes in the Shank with the Adjustable head (to the required height).
- 2 Insert the Pull Pins through the Adjustable head and Shank and secure with R-Clips.
- 3 Ensure both Pull Pins and R-Clips are used.

